

# MobiTech® Clinic Anywhere

The fully equipped mobile clinic for specialists and general practitioners, based on typical aluminum lightweight construction and high-strength polyurethane foams, provides the highest level of room quality and versatility. Naturally air conditioned, supplied with water and with sewage discharge, the mobile clinic is equipped with the latest medical technology. The durable, insensitive and lasting interior equipment is easy to keep hygienic clean.

The mobile clinic can be used everywhere and is multifunctional. Places of use can be accessed via ground, air and water. Dimensions of the *MobiTech®* match the globally common 20' ISO Standard. Tested in difficult terrain as well as under extreme climatic conditions and tried by local public health offices and emergency doctors, the mobile clinic proves time and again its strength.

*MobiTech®* Mobile Clinic can be used at places with inadequate provision of medical care where, due to their geographical location or social situation, people need help. The medical equipment according to customer request

## Specifications

<b>Internal dimensions</b>	Length	5,925 mm
	Width	2,305 mm
	Height	2,291 mm
	Working space	approx. 12 sqm
<b>Weight (without trailer)</b>	Dead weight	approx. 1,500 kg

## Design

*MobiTech® Anywhere* facility is a full aluminum lightweight sandwich construction with PU foam RG 50, white, front side door with window, windows in the side wall

## Attachments

Roof hatch, aux. access steps, entrance step, and detachable marquee

## Electrical equipment

- 230 V power supply with automatic circuit breakers
- CEE outside socket outlet
- 230 V interior light
- 230 V examination light
- 230 V socket outlets

## Heating and air-conditioning

- 230 V warm-air heating system
- 230 V compact air-conditioning unit

## Water

- wash basin
- Sewage disposal and fresh water mains

## Interior equipment

### Fixed installations:

- base unit module
- wall-cupboard module
- anamnesis place
- storage table
- partition
- antiskid PVC covering

## Medical engineering features

Medical engineering features are project specific according to customer requirements, e.g. dentist, ENT specialist, gynecology, ophthalmologist, radiologist, laboratory doctor, pulmonary specialist, tropical doctor, orthopedics



## Contact Us

[info@mobitechca.com](mailto:info@mobitechca.com)

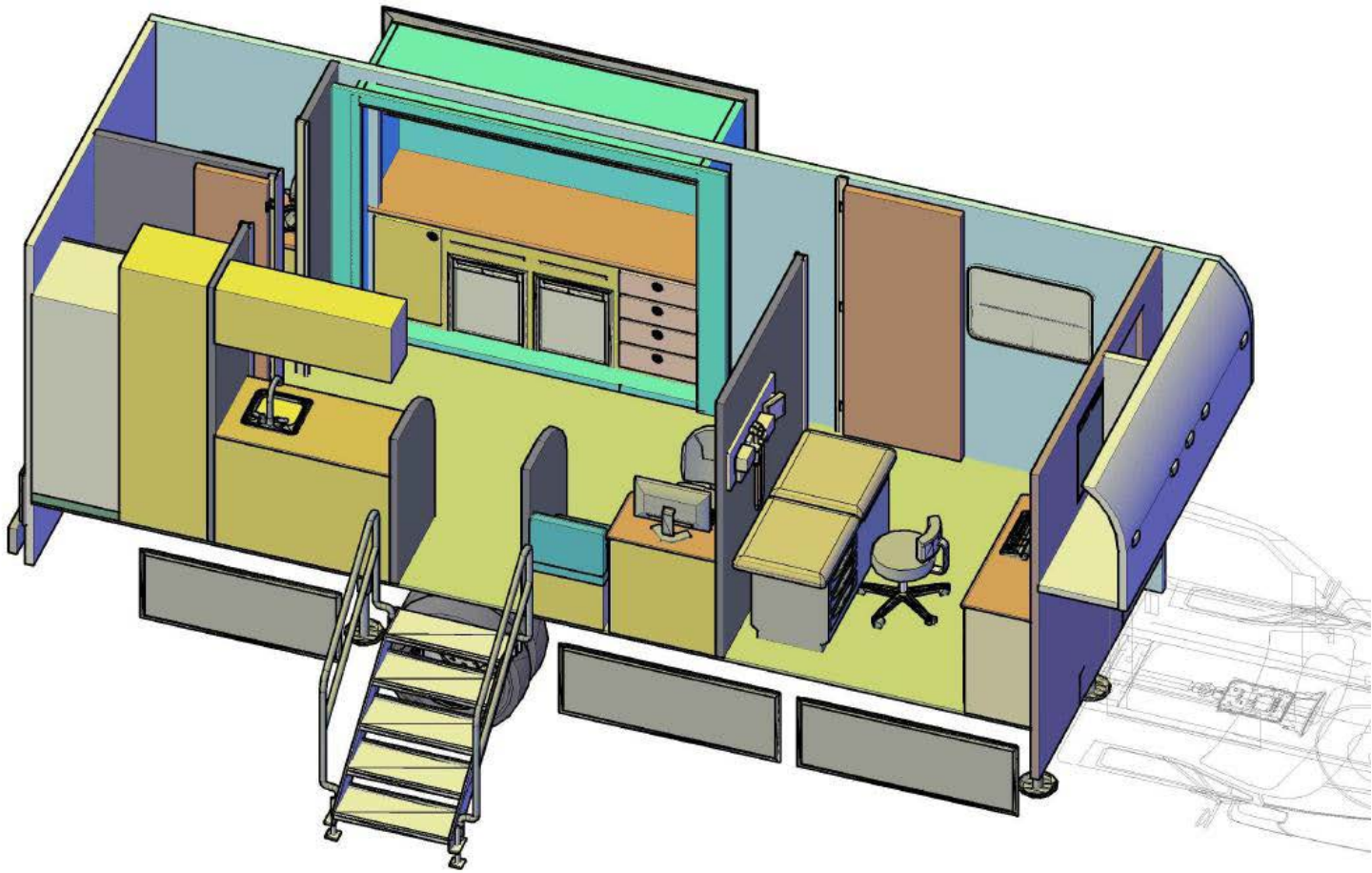

### Partitions

1. Consulting/screening room: contain examination couch screwed to the floor, 1 collapsible desk and 2 chairs.
2. Waiting area/Reception
3. Side lab/ procedure / sterilizing room: contain 2 collapsible chairs and a desk screwed to the floor.
4. kitchen
5. Dispensary
6. Toilet: porcelain vacuum toilet with water flushing, sewage holding tank.
7. Technical area